

STRAINER

1 CHARACTERISTICS AND BENEFITS

- Flanged armature for cleaning neutral gaseous and liquid media
- Strainers protect valves, improve the system's reliability and lower the costs of maintenance
- High mesh width light – low chance of clogging
- Simple dismantling of the screen for cleaning
- Cleaning cover plug ½"
- Small loss of pressure due to optimum hydraulic form
- Max. flow speed for liquids 4 m/s at PN16, 5m/s at PN25, for gases 35 m/s
- Constructions with a normal screen and a fine screen widen the range of application
- Simple handling and maintenance
- External coloured in RAL 9006

ART. 024

DN 15–200
PN 25/40 – cast steel

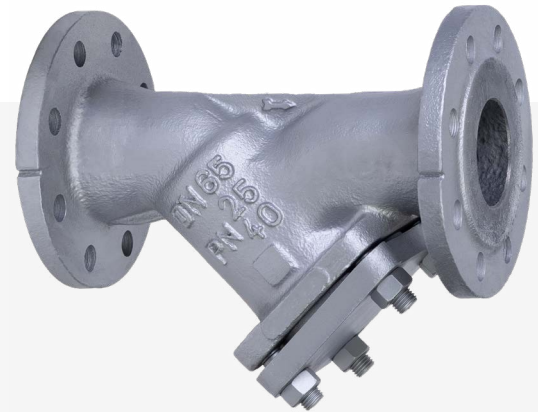

2 STANDARDS

- Manufactured acc. to the EU Pressure Equipment Directive PED 2014/68/EU
- Body material acc. to EN 10213, cover to DIN 17100
- Strength calculated acc. to EN 12516-2
- Flanges acc. to EN 1092-1
- Installation length acc. to EN 558-1, series 1 (DIN 3202, F1)
- EN 19 Specification
- Final strength and tightness test acc. to EN 12266-1

ON DEMAND

POSSIBLE ADDITIONS

- Without cover plug
- PN 6/10/16, ANSI 150 flanges
- Screen other density
- Magnet inserts
- Ball valve taps
- Manometer connections

SPARE PARTS

- Gaskets
- Screens
- Cover

3 APPROVALS

- CE mark
- EAC for the Russian market
- Compliance with requirements of Ukrainian and Lithuanian markets
- EMI for the Hungarian market
- VIK for the Croatian market

PN	25	40
Max. operating pressure* [bar]	25	40
Temperature resistance of colour coating [°C]	400	400
Max. operating temperature* for neutral liquids [°C]	400	400
Shell strength and tightness: test with water; rate A [bar]	37,5	60

* Maximum operating temperature depends of the mounted materials and pressure.

TECHNICAL DRAWINGS

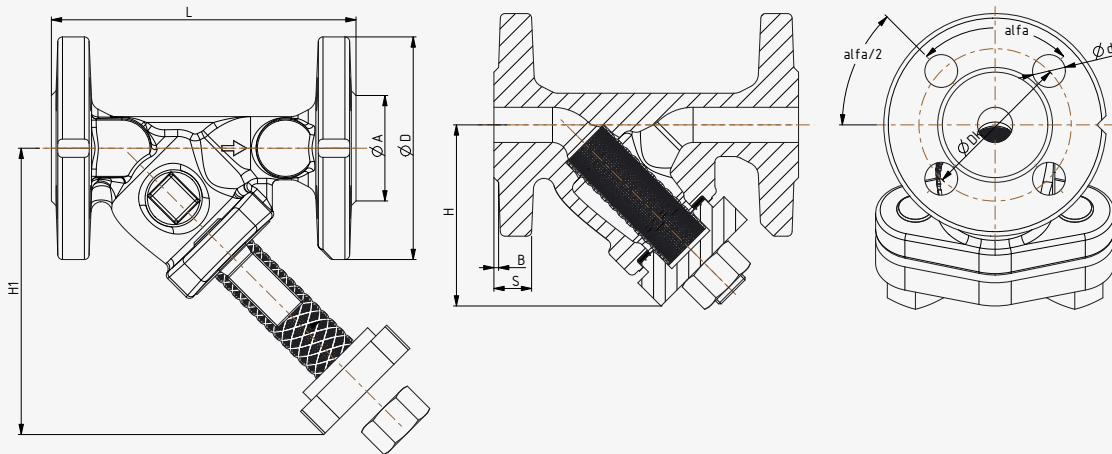

DATA

DN	15	20	25	32	40	50	65	80	100	125	150	200	
L [mm]	130	150	160	180	200	230	290	310	350	400	480	600	
A [mm]	80	80	100	110	125	145	160	175	230	270	320	380	
B [mm]	135	130	165	170	190	220	240	275	350	410	490	585	
Dk PN25 [mm]	65	75	85	100	110	125	145	160	190	220	250	310	
Dk PN40 [mm]	65	75	85	100	110	125	145	160	190	220	250	320	
d PN25 [mm]		14				18			22	26		26	
d PN40 [mm]		14				18			22	26		30	
Normal screen	Mesh light [MW]	0,54		0,87				1,18					
	Qty loops/cm ²	150		64				25					
	Kv [m ³ /h]	4,32	7,46	11,43	17,98	27,52	41,54	67,93	100,48	154,54	239,59	345,02	623,05
	ζ [-]	4,34	4,6	4,78	5,19	5,41	5,79	6,19	6,49	6,7	6,8	6,8	6,59
Fine screen	Mesh light [MW]	0,25											
	Qty loops/cm ²	625											
	Kv [m ³ /h]	4,14	7,16	10,83	17,25	26,59	41,2	66,32	97,38	148,73	232,38	334,64	604,03
	ζ [-]	4,72	4,99	5,33	5,64	5,79	5,89	6,49	6,91	7,23	7,23	7,23	7,02
Weight [kg]	3,02	3,75	5,58	6,93	8,3	11,4	15,46	22,4	34,74	50,25	79,5	157	

MATERIALS

	BASIC VERSION	SPECIAL VERSIONS ON DEMAND (differences from basic version)
Body	EN GP240GH/W. Nr. 1.0619	
Cover	EN P265GH/W. Nr. 1.0425	
Cover gasket	Novaphit	BA-U/viton/EPDM/NBR
Cover screws	W. Nr. 1.7709	A2
Cover plug ½"	A2	---
Screen	W. Nr. 1.4301 expanded	1.4401
Screen carrier	W. Nr. 1.4301 expanded	1.4401/perforated
Colour coating	RAL9006 min. 40 µm	